

## Easy User Guide;

### Vaillant VRC 430 – wall mounted

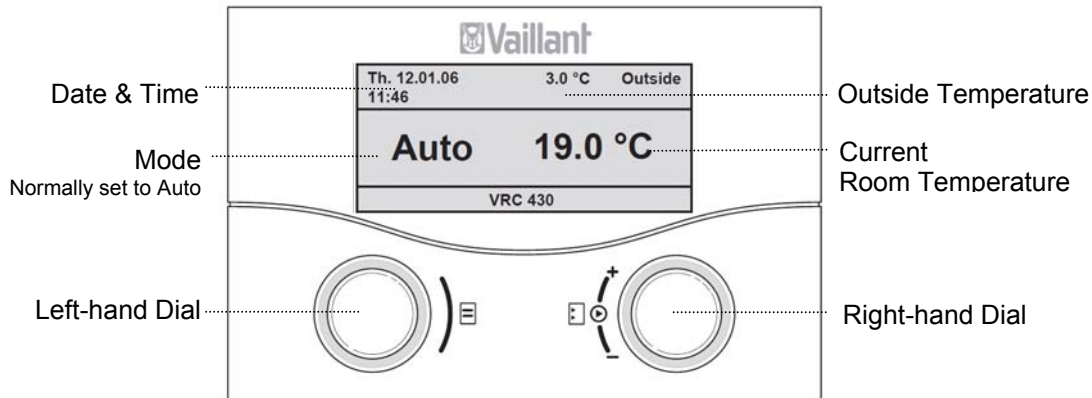





## Changing Room Temperature

The following steps will change the current room temperature.

- Turn the **right-hand dial clockwise or anti-clockwise**. The current room temperature will be highlighted and replaced by the desired room temperature.
- When the desired new temperature is shown highlighted simply leave the control for 3 seconds. The control automatically accepts the new setting and the display changes back to show the current room temperature again.

## Selecting Operating Mode

By turning the **left-hand dial clockwise or anti-clockwise** the modes will become highlighted. When the desired mode is shown highlighted simply leave the control for three seconds. The highlighted section will revert back to normal and the desired mode has been set. Modes are shown below.

<b>Auto</b>	Heating and hot water follow the <b>Time and Temperature Programmes already set in the control</b> . These programmed into menu screens  2 heating and  4 hot water.
<b>Manual</b>	Heating and hot water are <b>on</b> constantly and the temperature is controlled according to those programmed into menu screens  2 heating and  4 hot water.
<b>Off</b>	Heating and hot water are <b>off</b> . Frost protection is active.

**If you press either dial by mistake simply wait until the display changes back to the normal display before proceeding.**

## Easy User Guide;

### Vaillant VRC 430 – wall mounted

To change the programmed times or temperatures, please follow the steps shown below.

### Setting Time and Temperature Programmes

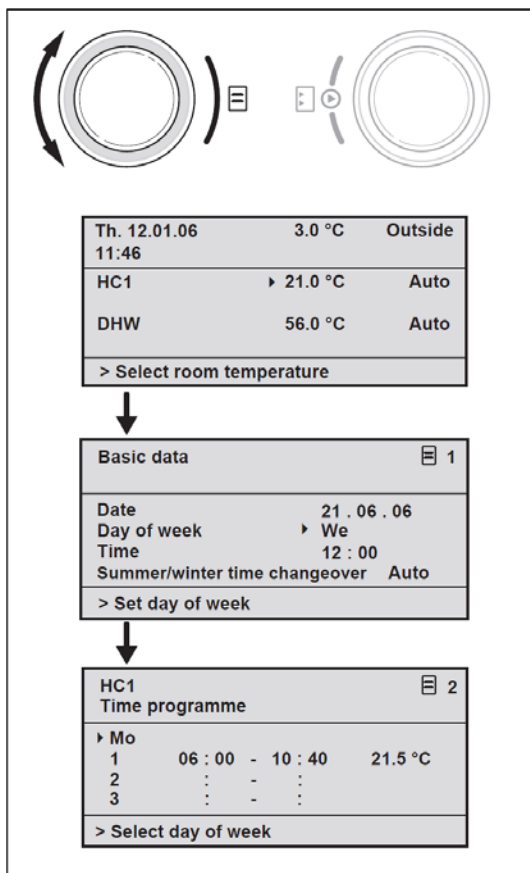

- Press the **right-hand** dial and the display changes to show the menu screens that can be changed.
- Turn the **left-hand** dial to move through the screens until you reach the screen that you need to change.
- Turn the **right hand** dial to move to the cursor ▶ to the setting on the screen you need to change. Use the following sequence for any changes to the control settings:
  - Press to select (setting is highlighted)
  - Turn to change to required setting.
  - Press to accept setting (highlight clears)

Once all times and temperatures have been set as required - simply leave the control to revert to the normal display screen.

For more advanced functions and settings please refer to the operating and installation manual.